

# INDUSTRIAL

## SH MOUNTS



# SH Mounts

## DESCRIPTION

Each mount consists of two heavy duty square outer plates with corner hole fixings fully bonded to circular profiled rubber layers separated by interleaf plates.

The type SH mounts provide high static and shock load capacities in compression with a minimum deflection, maintaining a low shear stiffness rate.

### Technical Characteristics

- The type SH mounts are designed for long lasting heavy duty applications.
- They can be supplied in 3 different hardness and 3 different sizes to suit applications where the compression load per mount is between 2 to 40 Tons.

### Applications

- High compression capacity, low shear stiffness and relatively low installed heights make the mounts ideal for: Vibratory rollers, Mills, Presses, Heavy machinery, Feeder screens.
- Due to their high load capacity these mounts are also used as point bearings for the vibration isolation of building structures.

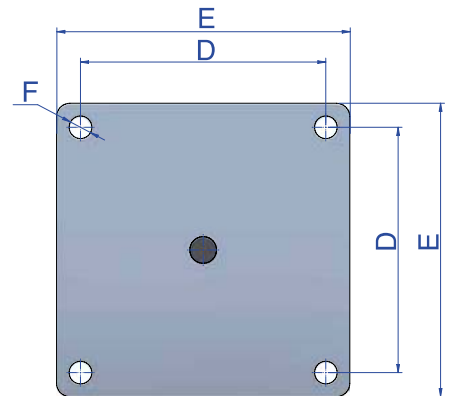
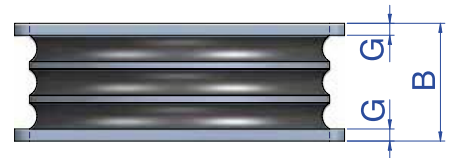

Type	B (mm)	D (mm)	E (mm)	F (mm)	G (mm)	Weight (gr.)	Code	Load (kg)	Shore
SH 125	52	118	148	13,5	5	2,5	148213 148215	2250 4500	45 Sh 60 Sh
SH 150	63	136	166	13,5	6	4,5	148201 148202	3750 7500	45 Sh 60 Sh
SH 200	78,5	184	220	17	8	9	148204 148205	6000 12000	45 Sh 60 Sh
SH 300	120	270	310	22	10	27	148207 148208 148209	15000 30000 40000	45 Sh 60 Sh 70 Sh

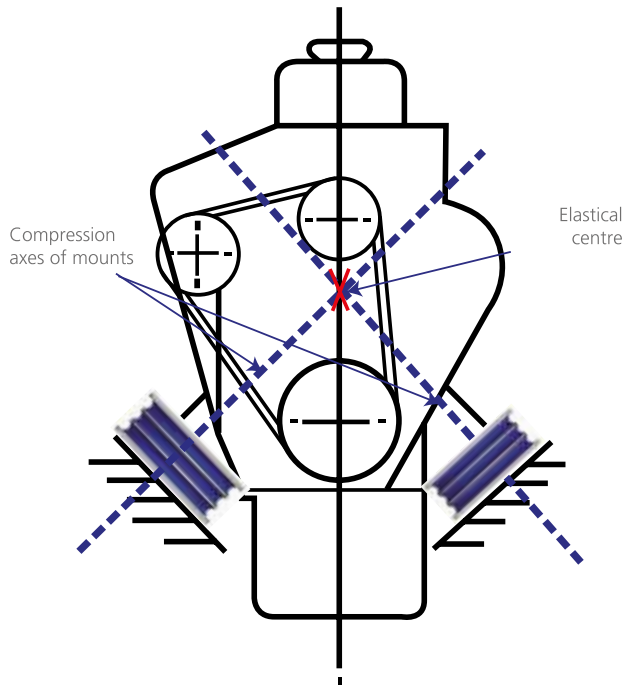

"VEE" Inclined Installation Configuration

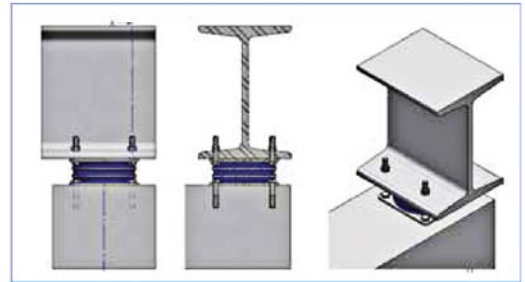
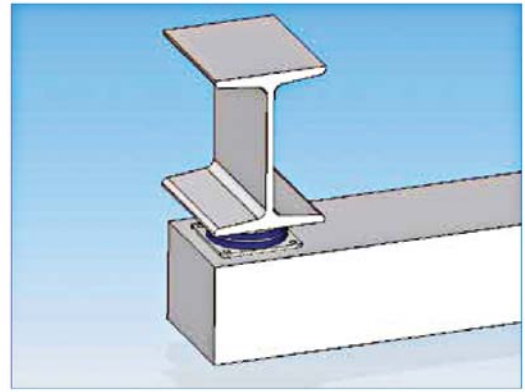

### Natural Frequency Dynamic SH Mount

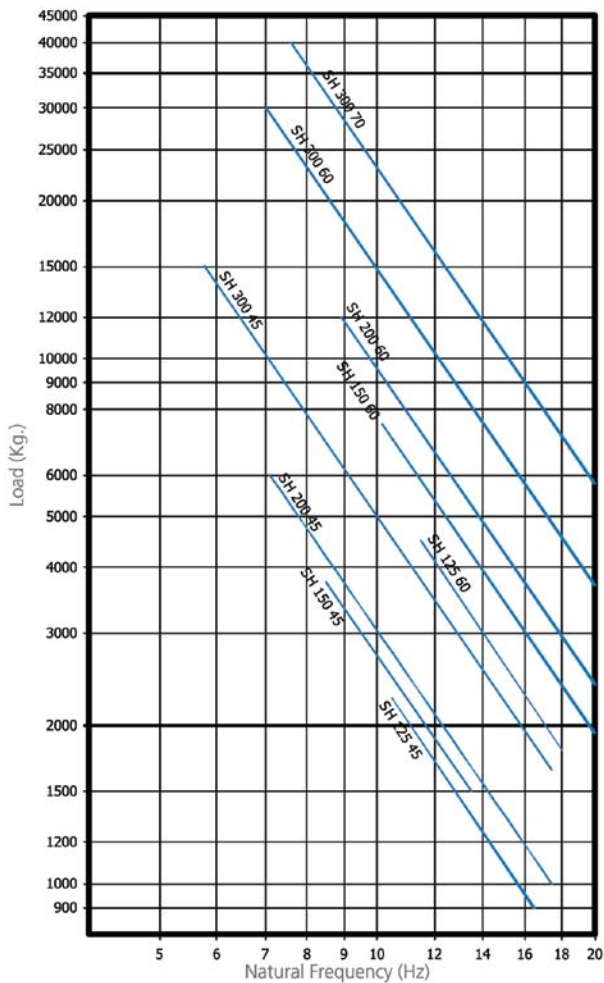

### Load Deflection Graph SH Type Mount

